



火の安心を、つくろう。
Wishing for Your Safety



YAMATO PROTEC CORPORATION

TOKYO OFFICE:17-2, SHIROKANEDAI 5-CHOME, MINATO-KU, TOKYO

Website

<https://www.yamatoprotec.co.jp/>



For inquiries, please scan the two-dimensional barcode to access the site.



※The product shown in this manual is subject to changes without notice for improvement. 2604-2

1 PART NAME

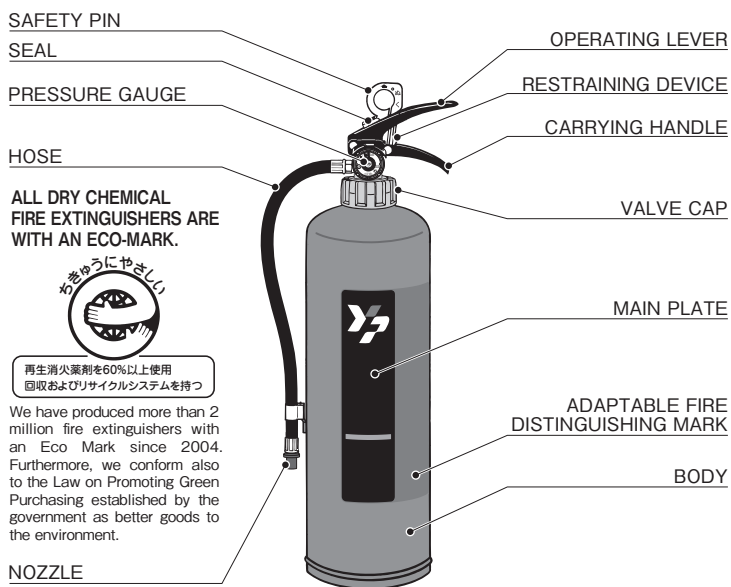

Depending on the type of materials to burn, fire can be roughly classified into the following three categories:

●Class A fire (normal fire)

Fire of wood, paper or fibers.

●Class B fire (oil fire)

Fire of petroleum oil and other inflammable liquid and semi-solid fat & oil.

●Class C fire (electrical fire)

Fire of conductive materials due to electricity.

◆Applicable fire indication marks



For normal fire
Class A fire



For oil fire
Class B fire



For electrical fire
Class C fire

White round mark Yellow round mark Blue round mark

Select appropriate fire extinguishers in accordance with the above three classes. In other words, it is necessary to select and install suitable fire extinguishers depending on the objects for fire prevention. Fire extinguishers have a name plate with a mark indicating the applicable type of fire.

2 METHOD OF OPERATION

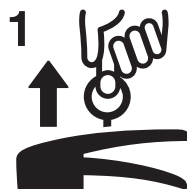

安全栓を引き抜く
PULL OUT SAFETY PIN.



ホースをはずし火元に向ける
RELEASE HOSE.
AIM AT BASE OF FIRE.

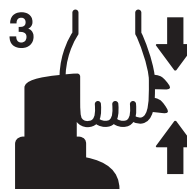

レバーを強くにぎる
SQUEEZE LEVERS.

Cautions for operation

- Refrain from taking out the safety pin while grasping the operation lever. Otherwise, it would be caught by the lever and gets hard to take out.
- Make sure of holding the fire extinguisher hose firmly when carrying out the fire extinguishing operation.
- Stay approximately 3meters away from the fire, and extinguish it by pointing the fire extinguisher hose to the base of the fire.
- The fire may regain its strength even when it has apparently extinguished once. Make sure of spraying the fire extinguishing agent until it runs out.

※Even when your fire extinguisher is provided with a stop function, which stops the spraying of the fire extinguishing agent when the lever is released, make sure of spraying it until it gets empty.

- When the fire is related to gas, make sure of shutting the master gas valve without fail after extinguishing the fire.

Instruction Manual

National approved products

- Make sure of going through this manual.
- Make sure of keeping this manual at a visible place.

CAUTION! PREVENTION OF HAZARD

Accidents may occur when the fire extinguisher is improperly installed, deteriorated or improperly handled. Make sure of strictly observing the instructions of this manual bearing DANGER, WARNING and CAUTION indications, so as to keep the fire extinguisher always available for use as a handy equipment for disaster prevention.

3 ABOUT THE FIRE EXTINGUISHING AGENT

- The fire extinguishing agent is not a toxic substance. It must be remembered, however, that it may be dangerous when inhaled in large quantities. Thus, make sure of handling the fire extinguisher with care.
- When the fire extinguishing agent has gotten into your eye, wash immediately with running water. If your eye is bloodshot or sore, consult a doctor.
- Do not eat any food on which the sprayed fire extinguishing agent is left.
- When the sprayed fire extinguishing agent is left, it gets damp and results into such problems as mold and corrosion of metallic parts. Moreover, the fire extinguishing agent reduces the insulation strength, so make sure of cleaning the electric equipment immediately.
- Ask for the service of experts for recharging the fire extinguishing agent after using it.
- When recharging the fire extinguishers, use our powder (ABC) fire extinguishing agents.
- The use limit of a fire extinguisher of which fire extinguishing agent is recharged repeatedly, when used for training for example, is 10 times. If recharging more than 10 times, the cap and the thread part of the ferrule may be damaged to cause a danger. Please ask for judgment of any professionally qualified person such as a dealer from which you bought or an office of YAMATO PROTEC.

Safety Instructions for Preventing Health Damage when Using the Fire Extinguisher

- Dry chemical fire extinguishing agent, made for extinguishing fire, is provided with a high degree of safety, and its effect on the body is slight.
- If you absorb the fire extinguishing agent under normal use, it might cause your eyes, nose, and/or throat to feel strange.
- Clean the fire extinguishing agent only in a well-ventilated area and with a protective device, such as a mask, that prevents absorption and adhesion of the fire extinguishing agent on your eyes, skin, or other parts of your body.
- If your body feels strange after using the fire extinguisher, receive a doctor's diagnosis.

JAPAN Fire Extinguisher Manufacturers Association

5 DAILY MAINTENANCE

- Refrain from using the fire extinguisher on trial. If you leave the fire extinguisher without proper care after using it on trial, it will not be available in an emergency.
- Inspect the equipment periodically and remove any waste or dust. (Please refer to check point)
- Check that the safety pin is sealed and set securely with the lever support set upright, and lock seal is attached.
- If the lock seal has been removed or is not attached, the fire extinguisher requires to be inspected.
- When cleaning the fire extinguisher, use a piece of cloth dampened with warm water and squeezed. Refrain from pouring water directly on the fire extinguisher. Otherwise water infiltrates in the spaces and other parts and causes rust and corrosion. Moreover, refrain from using organic solvents (thinner, benzene) and neutral detergents.
- Refrain from loosening screws, nuts and any other parts of the fire extinguisher.

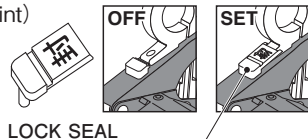

LOCK SEAL

4 ABOUT THE INSTALLATION OF THE FIRE EXTINGUISHER

- Install the fire extinguisher stably so that it will not fall down easily. Also, install it in a location not lower than 1.5m from an easily visible place.
- Placing the fire extinguisher directly on the ground may cause the fire extinguisher to be rusted, scratched, or deformed. Place it on a stand or in a case. Consult your dealer or an office of YAMATO PROTEC for wall fixtures and stands for installing the fire extinguisher.
- To prevent children from toppling over the fire extinguisher or misusing it, keep the fire extinguisher beyond the reach of children.
- Make sure of installing the fire extinguisher at a place where it is not exposed to strong shocks due to the fall of heavy objects and other causes.

■ CHECK POINT

PRESSURE GAUGE

Confirm that the indicator is within the green range [7.0~9.8($\times 10^{-1}$ MPa)].

※If the pressure is low, sufficient capability may not be brought out and the fire extinguishing agent may not be discharged.



■ Green range

LOCK SEAL

Confirm the lock seal.

※If there is no lock seal, the extinguisher may have been used.

SAFETY PIN

The safety pin should be vertically penetrated the restraining device.

※If there is no safety pin, the extinguisher may have been used.

OPERATING LEVER and CARRYING HANDLE

Should be without deformation · corrosion · breakage, etc.

※If there is anything wrong, there is a possibility that the extinguisher cannot be used.

VALVE CAP

Should be without deformation · corrosion · breakage, etc.

※Deformed or corroded cap may accidentally break and scatter. loose cap may lead to insufficient pressure.

DESIGN STANDARD SERVICE LIFE

Do not use products past the design standard service life.

※Please check the main plate.

BODY

Should be without rust, crack, or deformation.

※If there is anything wrong, proper discharge cannot be achieved.

NOZZLE

The nozzle should be free of cracks and not be clogged with dust or any foreign substances. The nozzle tip should be tightly attached.

※For fire extinguishers without a hose, please refer to the diagram on the right. The checkpoints other than the nozzle are the same.

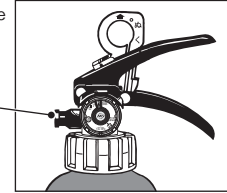

6 INSTRUCTIONS FOR USE

The fire extinguisher is a pressure vessel

⚠ DANGER

- Observe the following to avoid possible breakage:
- Never use fire extinguishers that have rust, damage, deformation or a loose cap.
- Do not disassemble the fire extinguishers. When disposing of fire extinguishers, contact your dealer or an office of YAMATO PROTEC.

⚠ WARNING

- Observe the following to avoid possible breakage or physical injury:
- Perform half-yearly inspections as provided by relevant laws and regulations.
- Perform hydrostatic testing by applying a hydrostatic test pressure to any fire extinguisher that was produced than 10 years ago.
- Do not install fire extinguishers at locations liable to corrosion and high humidity or subjected to salt breeze or wind and rain.
- Do not place them directly on the wet floor or on the ground.
- Do not install them at locations with temperatures exceeding the specified service temperature.
- Do not discharge fire extinguishing agents toward someone, which may cause hazard such as breathing difficulty.
- Keep away by at least three meters from the fire, to avoid possible burn injury when discharging fire extinguishing agents.
- Secure an escape route when engaged in fire fighting.

⚠ CAUTION

- The fire extinguisher is an apparatus for initial fire extinction. Extinguishing ability of the fire extinguisher is limited.
- Do not perform a trial discharge. A fire extinguisher after a trial discharge can no longer be used.
- Once used, the fire extinguisher shall be replaced with a new one or be recharged.
- Confirm if the fire is adaptable or not with the distinguishing mark on the face plate. Depending on the burning material, there is a fire suited or unsuited for use of this type of fire extinguisher.